

# Потолочные Решения

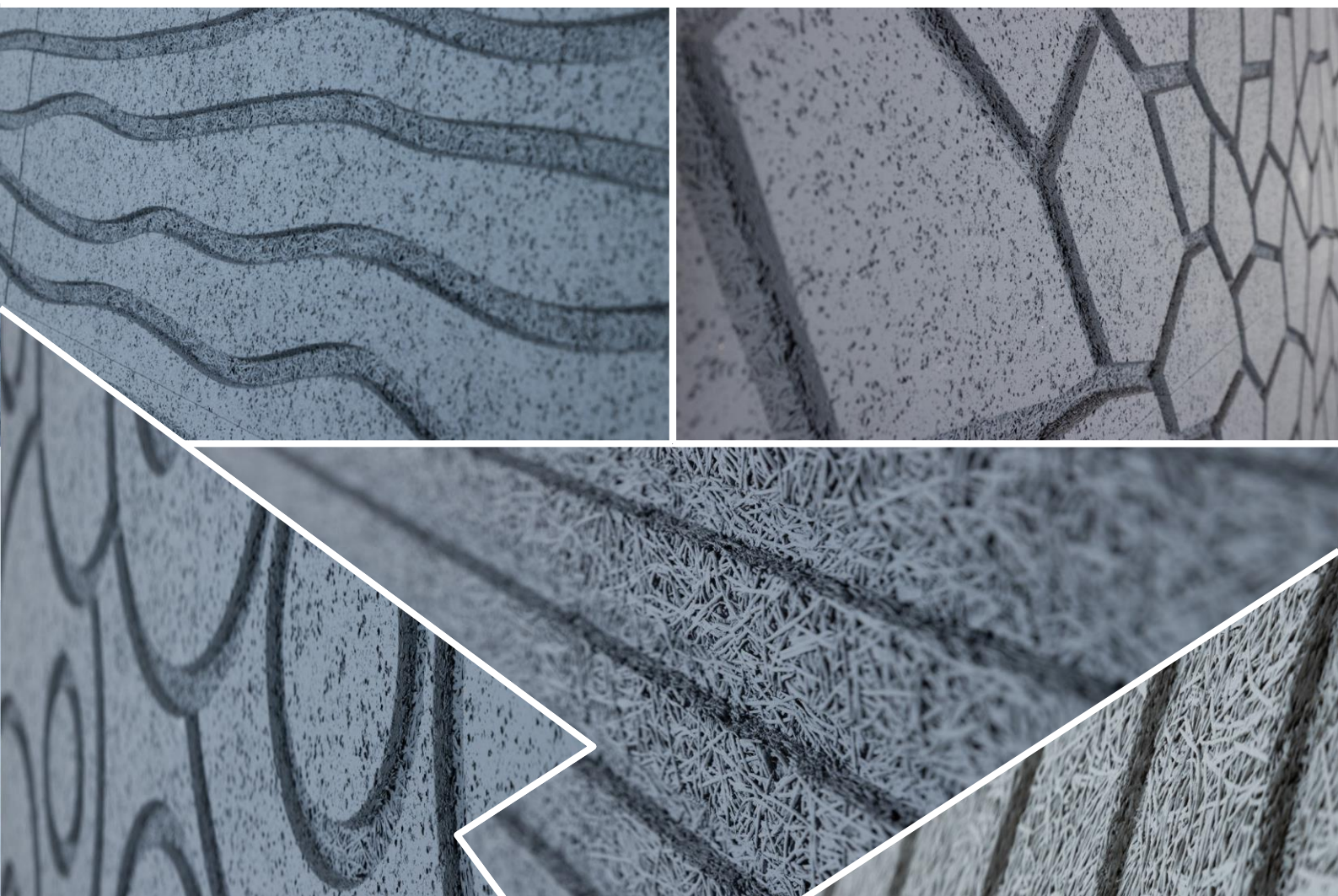

Акустические потолки и  
панели для стен.  
Создавайте эффективные  
пространства вместе с нами

**8(495)504-30-51**

**8(800)333-02-53**

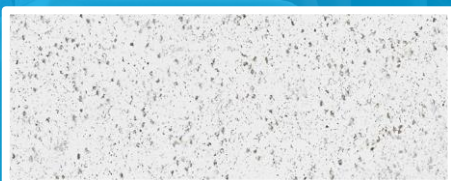
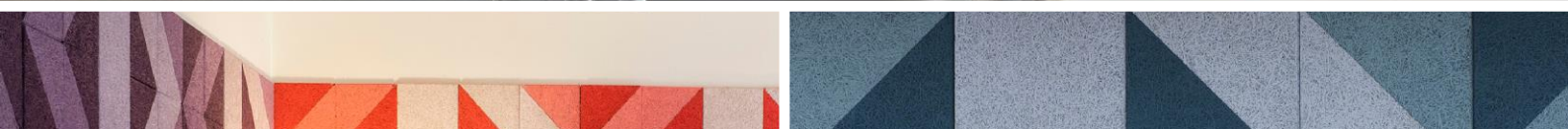









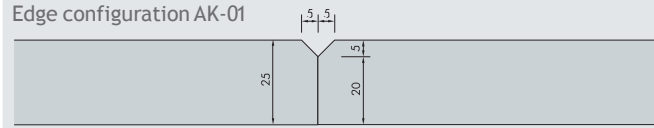

## HERADESIGN® Creative module

1-layer magnesite-bonded wood wool acoustic panel.

Depending on the design, available in the surfaces  
Fine, Superfine and Micro.

# HERADESIGN® Creative module

## PRODUCT DATA

	HERADESIGN® Fine	HERADESIGN® Superfine	HERADESIGN® Micro	
<b>Surfaces</b>				
<b>Edge details</b>	Edge configuration AK-01 			
<b>Thickness</b>	25 mm			
<b>Dimensions</b>	Grid size 300 and 600 mm			
<b>System</b>	For application on the ceiling mechanical fixation of the modules is mandatory. Adhesive installation for module 300 on appropriate substructure on the wall up to a height of 3m.			
<b>Weight</b>	12,6 - 15,0 kg/m <sup>2</sup>			
<b>Fire reaction</b>	Euroclass B-s1,d0 as per EN 13501-1			
<b>Sound absorption</b>	HERADESIGN® Fine: $\alpha_w$ up to 0,90 / NRC up to 0,90 HERADESIGN® Superfine: $\alpha_w$ up to 1,00 / NRC up to 1,00 HERADESIGN® Micro: $\alpha_w$ up to 0,55 / NRC up to 0,55			
<b>Thermal conductivity</b>	HERADESIGN® Fine: $\lambda = 0.090$ W/mK as per EN 12667 HERADESIGN® Superfine: $\lambda = 0.090$ W/mK as per EN 12667 HERADESIGN® Micro: $\lambda = 0.100$ W/mK as per EN 12667			
<b>Humidity resistance</b>	up to 90% RH			
<b>Cleanability</b>				
<b>Sustainability</b>				
<b>Areas of application</b>	As decorative and acoustically effective wall and ceiling claddings for use in interior areas.			
<b>Special information</b>	<ul style="list-style-type: none"> <li>Manufacturing tolerances in nominal dimensions: L4, W2, T2: <math>\pm 1</math> mm, for lengths &gt; 1250 mm L4: <math>\pm 2</math> mm</li> <li>Max. changes in dimension in standard climate 23° C / 50 %rel. humidity: <math>\pm 1</math> ‰</li> </ul>			
<b>Colour variants</b>	<b>Standard colours</b> white and beige	<b>Pastel colours</b>	<b>Solid colours</b>	<b>Special colours</b>
				
	<ul style="list-style-type: none"> <li>The natural characteristic structure of the wood wool is ideally suitable as a surface for creative colour schemes. An almost unlimited range of colours is available - almost any colour from popular colour systems such as RAL or NCS, may be selected.</li> <li>Deviations in colour from the edge colour and colour perception are possible due to the rough surface of the fibres or the surface of the panel.</li> </ul>			
				

## PRODUCT RANGE

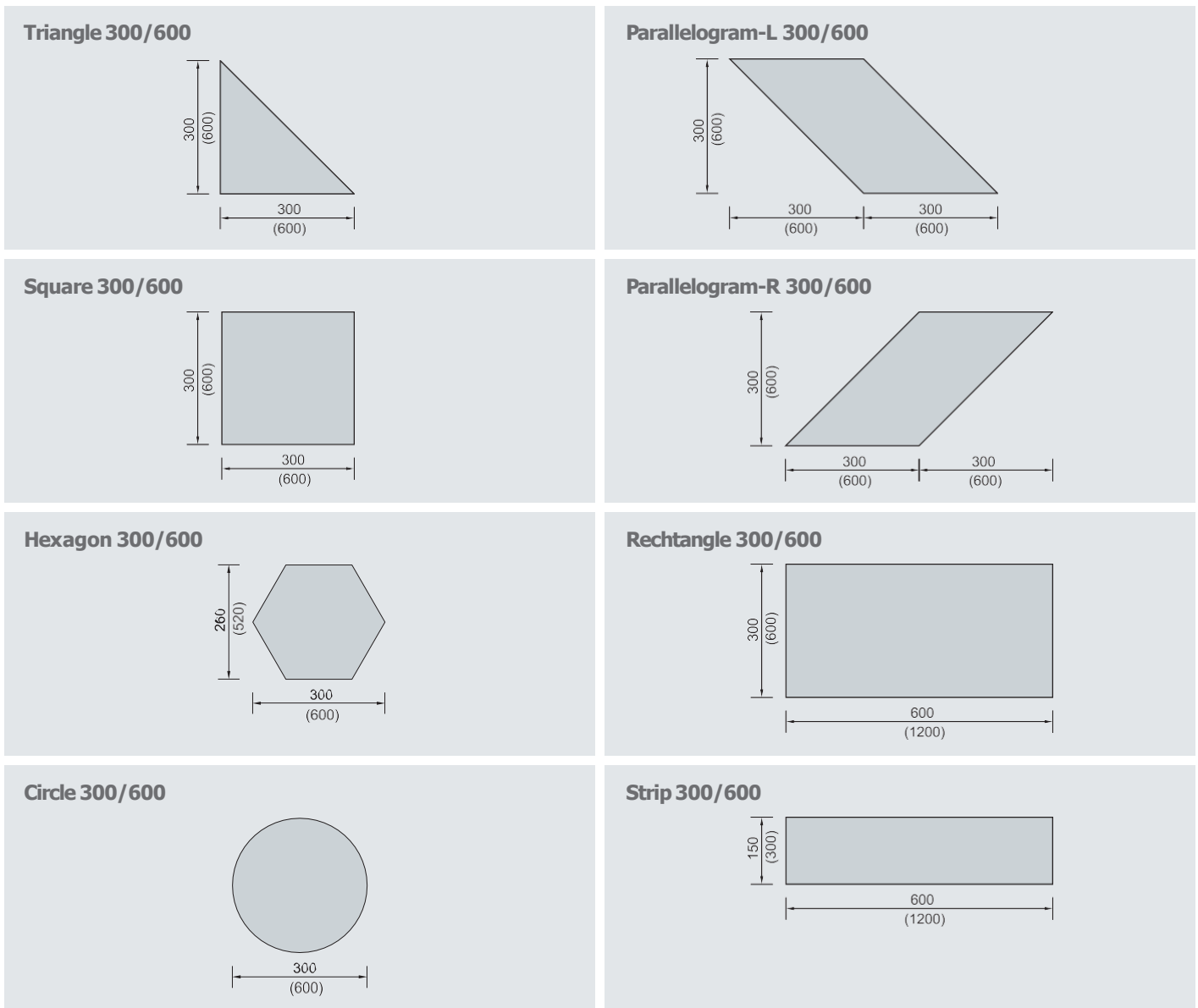

## TECHNICAL DATA

Requirement per m <sup>2</sup> of wall or ceiling area							
Description		Module 300 <sup>1)</sup>			Module 600 <sup>2)</sup>		
		Area [m <sup>2</sup> ]	Pcs./m <sup>2</sup>	Pcs./carton	Area [m <sup>2</sup> ]	Pcs./m <sup>2</sup>	Pcs./carton
	Triangle	0.045	22.22	28	0.180	5.56	40
	Parallelogram	0,090	11,11	7	0,360	2,78	10
	Square	0,090	11,11	14	0,360	2,78	20
	Rectangle	0.180	5.56	7	0.720	1.39	10
	Strip	0.090	11.11	14	0.360	2.78	20
	Circle	0.070	11.11	14	0.283	2.78	20
	Hexagon	0.058	17.25	14	0.234	4.27	20

<sup>1)</sup> Element 300: max. 20 cartons per palette. <sup>2)</sup> Element 600: max. 3 cartons per palette

## INSTALLATION

### Notes on installation guidelines

HERADESIGN® creative modules are produced, checked and transported to the construction site with great care.

When receiving the material, please always check:

- Number of package units (palettes, cartons, m<sup>2</sup>)
- Compare the contents of the package units with the delivery note and the labels on the packaging
- Accessories: plugs, screws, re-touch paint, profiles or other items
- Are the goods or parts damaged?

**IMPORTANT:** If there are any transport damages, insufficient quantities, or other discrepancies have this certified by the driver. Also, immediately inform the dealer that shipped the goods.

Important factors for a successful and attractive HERADESIGN® creative installation are exact processing and suitable working conditions. Only careful work and high product quality ensure a satisfactory result.

The installation of HERADESIGN® creative tiles is part of interior decorating and must only be carried out under controlled humidity and temperature conditions. All dust-causing construction measures must be completed before starting the installation.

Check the HERADESIGN® creative modules for damage before installation. Damaged tiles should not be installed.

Transport to site, unpacking the HERADESIGN® creative products and handling should always be carried out with due care. Always work with clean hands and clean tools. We recommend wearing clean gloves.

Before starting installation, check the underlying surface for loadbearing capacity.

When required, the modules can be cut using a circular saw, table saw or jigsaw. Remove any dust with a soft brush.

Slight damage to the tile surface as well as cut edges are carefully painted after installation. This is done with a fine brush.

Only apply a small amount of paint to avoid colour differences. Cut edges or later produced fibres can be painted with a short-haired roller (e.g. microfibre roller 13 mm, paint roller 10 mm, etc.) or brush.

When using the HERADESIGN® creative modules with screw installation, we recommend HERADESIGN® Bitholder “easy” for exact installation of the screws. The required screw depth must be set on a sample tile before installation.

### Variant of screw installation on the wall and on the ceiling

Alternatively, HERADESIGN® creative acoustic elements can be screw fixed onto 60 x 27 x 0.6 mm CD profiles or 30 / 60 mm wooden lathes. Screw type: HERADESIGN® screws, 50 x 4.5 mm.

Alternatively, grooved or resin-treated staples may be used. Staple width >8 mm, staple length >50 mm.

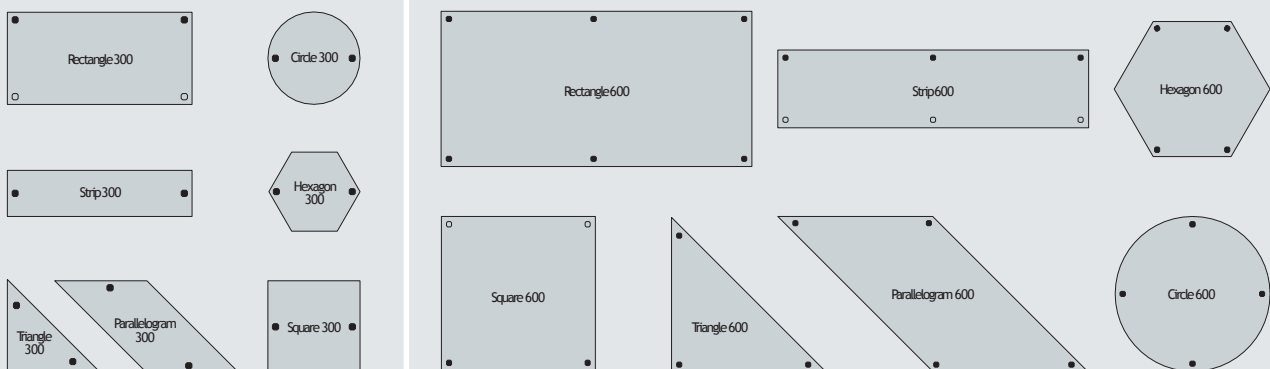

The location of the screws can vary depending on the pattern and substructure when using 300 mm elements.

## INSTALLATION

### Variant: Adhesive installation on the wall

The following installation guidelines refer to the adhesive installation of HERADESIGN® creative acoustic elements in 300 mm modules on the wall up to a maximum wall height of 3 m. For installation with HERADESIGN® screws, follow the corresponding procedure.

**Important:** The underlying surface must be able to take the load, level, dry and dust-free. Handling and underlying surface temperature min. +7 °C. Surfaces with unknown properties should be checked for their adhesion.

The general guidelines for the installation of HERADESIGN® wood wool acoustic tiles must be observed.

**1 | MARK**  
a horizontal guide.

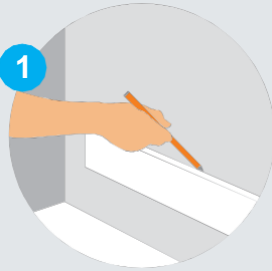

**6 | INSTALL THE FIRST ROW**

The first row must be installed with high accuracy. To ensure the elements don't slip and to ease alignment we recommend using a horizontal stop bar. Alternatively, the first row can be secured with screws or wall tacks.

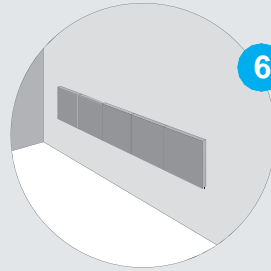

**2 | MARK**  
a vertical guide.

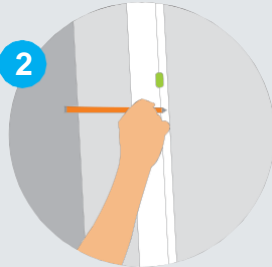

**7 | FURTHER ADHESIVE**

The next rows from the bottom are positioned and adhered. The position of the elements should be checked at regular intervals with a spirit level.

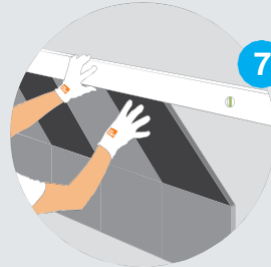

**3 | DEFINE THE MODULE**  
Depending on the type of module to be adhered, several guides in a 300 mm or 600 mm module may be necessary.

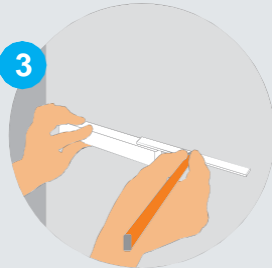

**8 | CHECK**

After completion, any colour damage or fibre breakage may be improved with a small brush and the supplied repair paint.

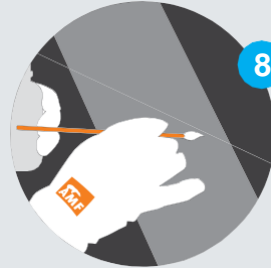

**4 | APPLY ADHESIVE**  
Apply a line of adhesive to the acoustic element. Knauf AMF recommends using Knauf POWER-ELAST. Processing time: approx. 15 min. Amount: approx. 1 cartridge/m².

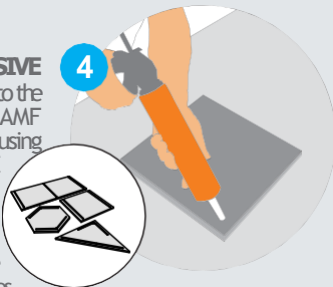

Illustrative example of the adhesive application lines.

**9 | ENJOY**

Completed wall installation

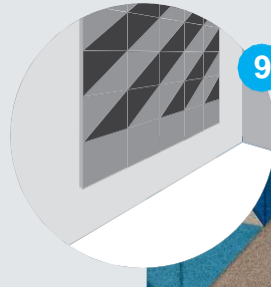

**5 | ALIGN**  
the elements to the module and adhere to the underlying surface by applying pressure.





## HERADESIGN® Creative line

1-layer magnesite-bonded wood wool acoustic panel.  
Available in the surfaces Fine and Superfine.

## PRODUCT DATA

		<b>HERADESIGN® Fine, Fine A2</b>	<b>HERADESIGN® Superfine, Superfine A2</b>				
<b>Surfaces</b>							
<b>Edge details</b>		Edge configuration AK-01 					
<b>Thickness</b>		25 mm					
<b>Dimensions</b>		1200 x 600 mm					
<b>System</b>		Screw-fix on wooden battens - System B2.1 Screw-fix on CD channels - System B2.2					
<b>Weight</b>		12,6 - 19,0 kg / m <sup>2</sup>					
<b>Fire reaction</b>		Euroclass B-s1, d0 and A2-s1, d0 as per EN 13501-1					
<b>Sound absorption</b>		HERADESIGN® Fine: $\alpha_w$ up to 0,90 / NRC up to 0,90 HERADESIGN® Superfine: $\alpha_w$ up to 1,00 / NRC up to 1,00 HERADESIGN® Fine A2: $\alpha_w$ up to 0,75 / NRC up to 0,80 HERADESIGN® Superfine A2: $\alpha_w$ up to 0,95 / NRC up to 1,00					
<b>Thermal conductivity</b>		HERADESIGN® Fine, Superfine: $\lambda = 0.09$ W / mK as per EN 12667 HERADESIGN® Fine A2, Superfine A2: $\lambda = 0.10$ W / mK as per EN 12667					
<b>Humidity resistance</b>		up to 90% RH					
<b>Cleanability</b>							
<b>Sustainability</b>							
<b>Areas of application</b>		As decorative and acoustically effective sub-ceiling and wall cladding for use in interior rooms and roofed outdoor areas, which are not exposed to direct environmental influences such as rain or pollutants.					
<b>Installation</b>		Installation of HERADESIGN® acoustic panels is part of the interior fitting of the building and must only be carried out under conditions of controlled humidity and temperature. All building activities which create dust must be completed before the start of installation. Store the panels flat and protect against moisture and dirt. The packaging does not protect the products against rain! Also note the relevant application, installation and storage guidelines for HERADESIGN® acoustic panels.					
<b>Special information</b>		<ul style="list-style-type: none"> <li>Manufacturing tolerances in nominal dimensions: L4, W2, T2: <math>\pm 1</math> mm, for lengths &gt; 1250 mm L4: <math>\pm 2</math> mm</li> <li>Max. changes in dimension in standard climate 23 ° C / 50 % rel. humidity: <math>\pm 1</math> %</li> </ul>					
<b>Colour variants</b>		<b>white</b> similar to RAL 9010	<b>beige</b> Natural tone 13	<b>Pastel colours</b>	<b>Solid colours</b>	<b>Metallic colours</b>	<b>Special colours</b>
		●	●	●	●	●	●
		<ul style="list-style-type: none"> <li>The natural characteristic structure of the wood wool is ideally suitable as a surface for creative colour schemes. An almost unlimited range of colours is available - almost any colour from popular colour systems such as RAL or NCS, may be selected.</li> <li>Deviations in colour from the edge colour and colour perception are possible due to the rough surface of the fibres or the surface of the panel.</li> </ul>					



## PRODUCT RANGE

Line DL 16



Line DL 8

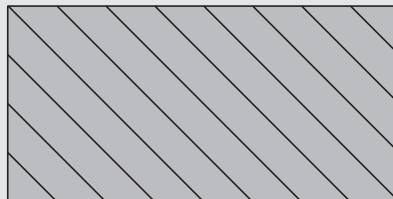

Line DR 16



Line DR 8

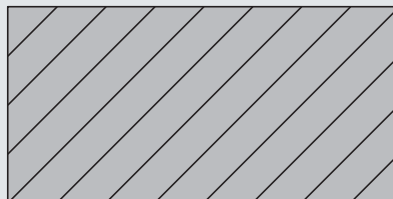

Line DLR 16

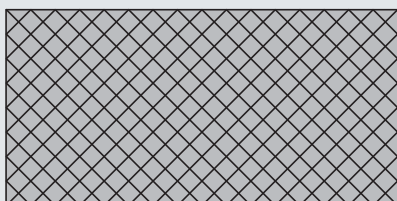

Line DLR 8

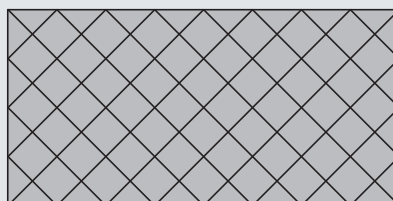

Line V 16

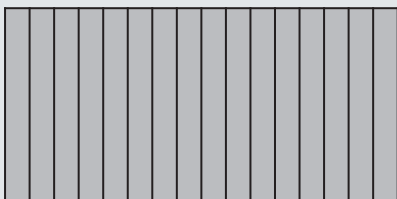

Line V 8

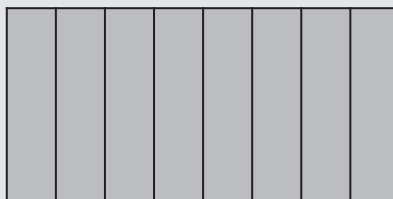

Line H 16



Line H 8

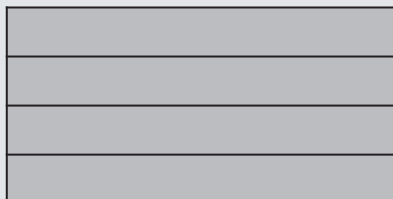

Line VH 16

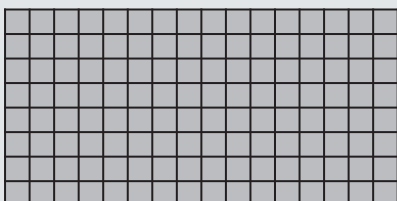

Line VH 8

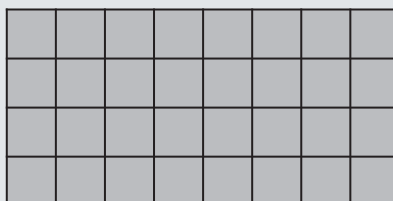

Products may vary from country to country. Please contact your local sales representative.  
For further information and legal notice, please visit our website.

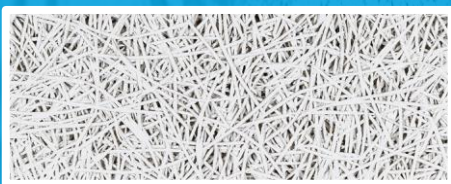
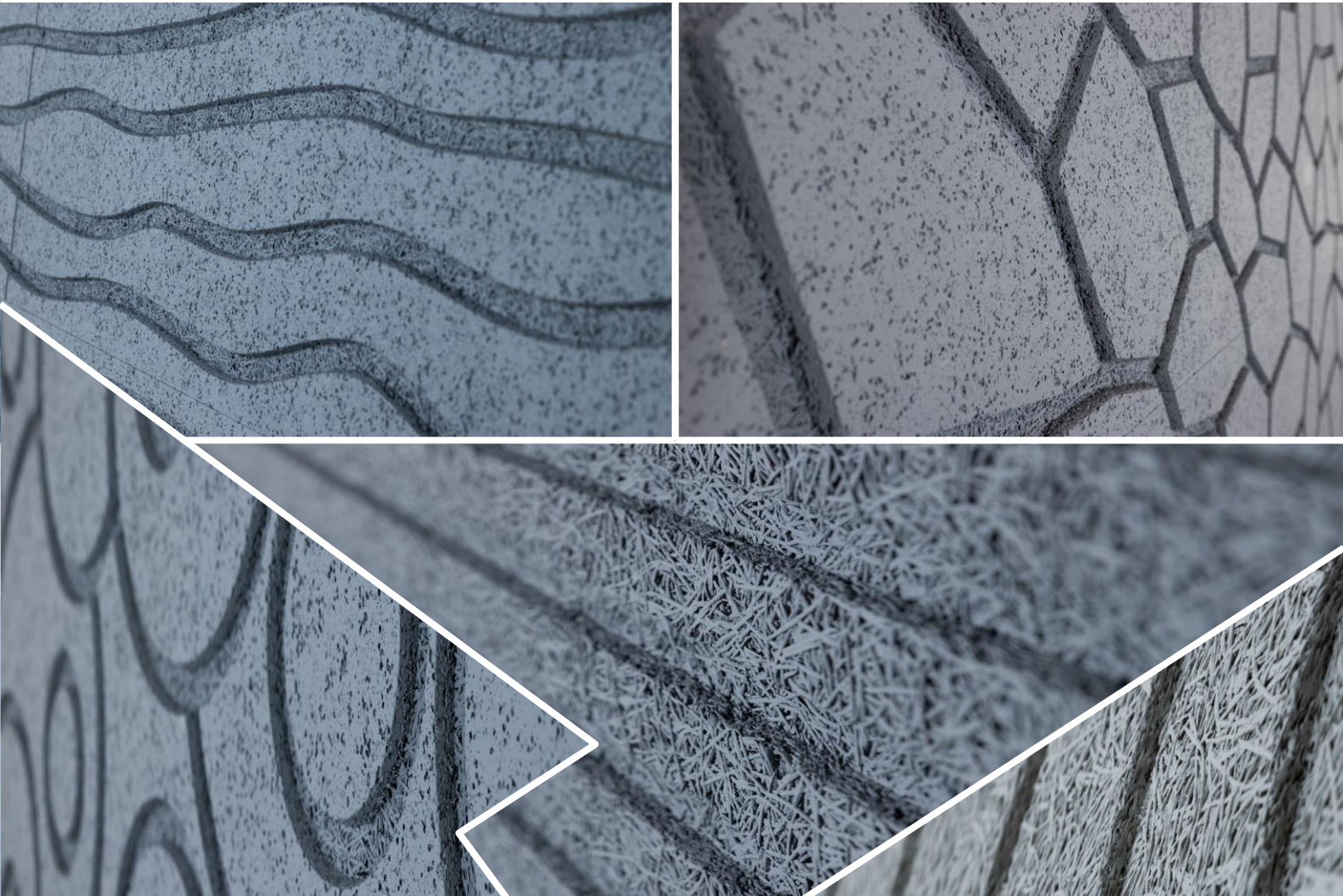

## HERADESIGN® Creative effect

1-layer magnesite-bonded wood wool acoustic panel  
with various „endless patterns“.  
Depending on the design, available in the surfaces  
Superfine, Micro and Plano.

## PRODUCT DATA

		<b>HERADESIGN® Superfine</b>	<b>HERADESIGN® Micro</b>	<b>HERADESIGN® Plano</b>		
<b>Surfaces</b>						
<b>Edge details</b>						
<b>Thickness</b>		25 mm				
<b>Dimensions</b>		1200 x 600 mm				
<b>System</b>		Screw-fix on wooden battens - System B2.1 Screw-fix on CD channels - System B2.2				
<b>Weight</b>		12,6 - 15,0 kg/m <sup>2</sup>				
<b>Fire reaction</b>		Euroclass B-s1,d0 as per EN 13501-1				
<b>Sound absorption</b>		HERADESIGN® Superfine: $\alpha_w$ up to 1,00 / NRC up to 1,00 HERADESIGN® Micro: $\alpha_w$ up to 0,60 / NRC up to 0,60				
<b>Thermal conductivity</b>		HERADESIGN® Superfine: $\lambda = 0.09$ W/mK as per EN 12667 HERADESIGN® Micro, Plano: $\lambda = 0.10$ W/mK as per EN 12667				
<b>Humidity resistance</b>		up to 90% RH				
<b>Cleanability</b>						
<b>Sustainability</b>						
<b>Areas of application</b>		As decorative and acoustically effective sub-ceiling and wall cladding for use in interior rooms.				
<b>Installation</b>		Installation of HERADESIGN® acoustic panels is part of the interior fitting of the building and must only be carried out under conditions of controlled humidity and temperature. All building activities which create dust must be completed before the start of installation. Store the panels flat and protect against moisture and dirt. The packaging does not protect the products against rain! Also note the relevant application, installation and storage guidelines for HERADESIGN® acoustic panels.				
<b>Special information</b>		<ul style="list-style-type: none"> <li>Manufacturing tolerances in nominal dimensions: L4, W2, T2: <math>\pm 1</math> mm, for lengths &gt; 1250 mm L4: <math>\pm 2</math> mm</li> <li>Max. changes in dimension in standard climate 23° C / 50 %rel. humidity: <math>\pm 1</math> ‰</li> </ul>				
<b>Colour variants</b>		<b>white</b> similar to RAL 9010	<b>beige</b> Natural tone 13	<b>Pastel colours</b>	<b>Solid colours</b>	<b>Special colours</b>
		●	●	●	●	●
		<ul style="list-style-type: none"> <li>The natural characteristic structure of the wood wool is ideally suitable as a surface for creative colour schemes. An almost unlimited range of colours is available - almost any colour from popular colour systems such as RAL or NCS, may be selected.</li> <li>Deviations in colour from the edge colour and colour perception are possible due to the rough surface of the fibres or the surface of the panel.</li> <li>The colour application in the milled cut-outs may differ from the colour application on the surface of the panel.</li> </ul>				

## PRODUCT RANGE

**Groove-H: HERADESIGN® Superfine, Micro, Plano**

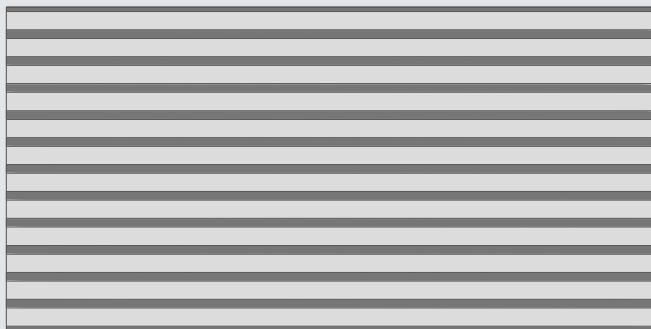

**Groove-V: HERADESIGN® Superfine, Micro, Plano**

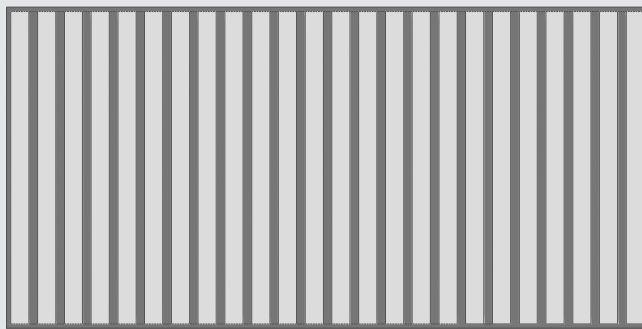

**Zig Zag: HERADESIGN® Micro, Plano**

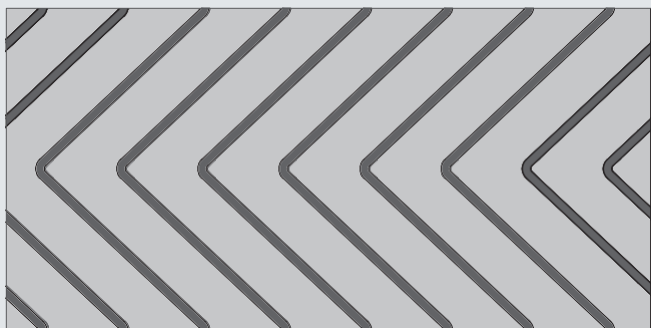

**Mikado: HERADESIGN® Superfine, Micro, Plano**

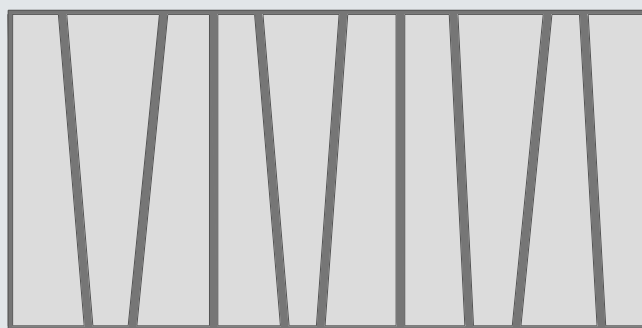

**Wave-V: HERADESIGN® Micro, Plano**

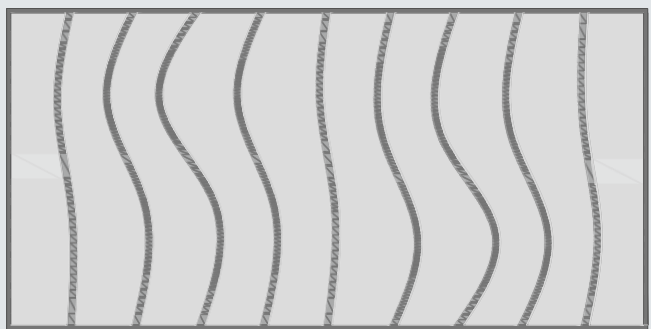

**Wave-H: HERADESIGN® Micro, Plano**

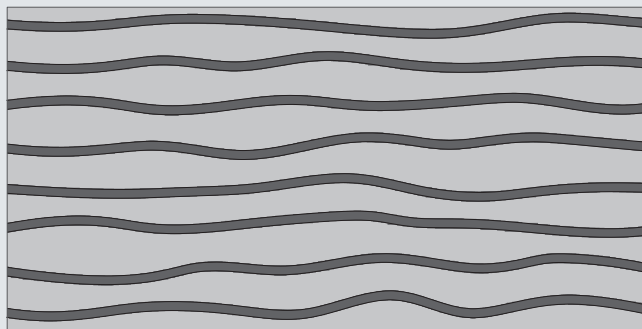

**Bubbles: HERADESIGN® Micro, Plano**

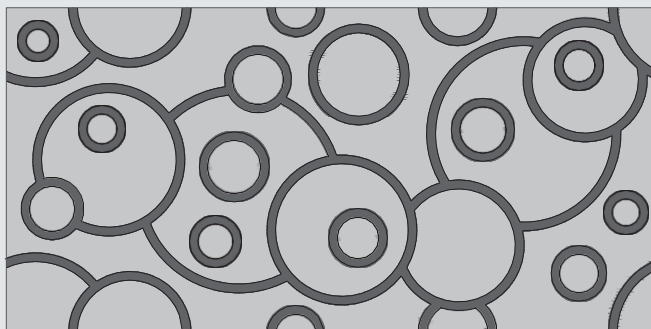

**Turtle: HERADESIGN® Micro, Plano**

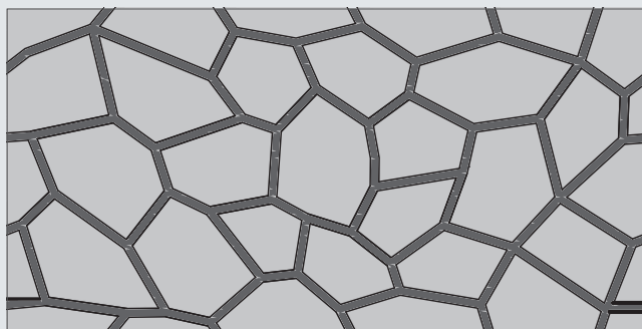

## PRODUCT APPLICATION

**Groove-H**

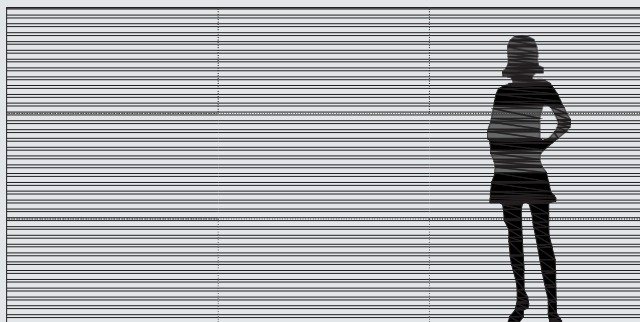

**Groove-V**

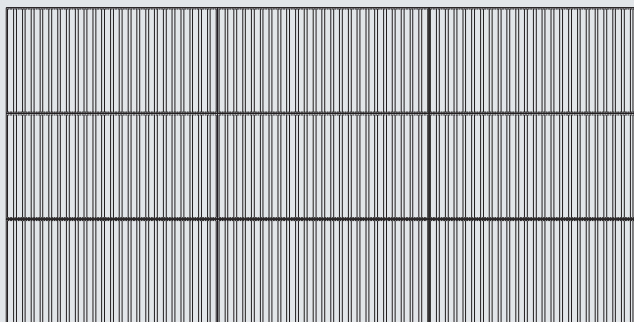

**Zig Zag**

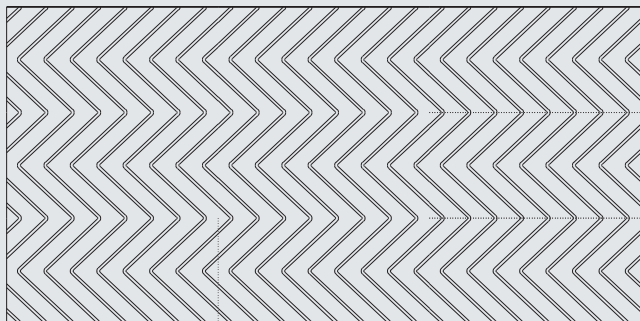

**Mikado**



**Wave-V**

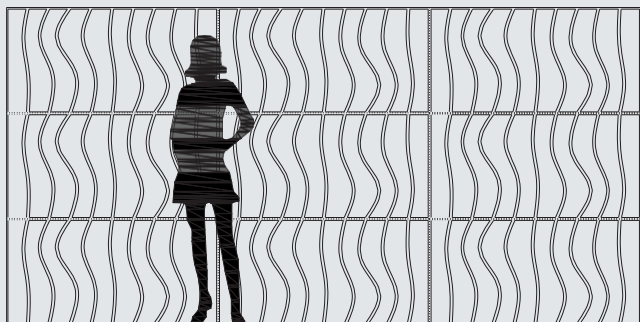

**Wave-H**

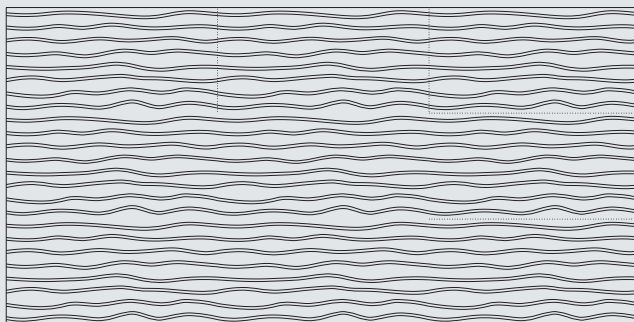

**Bubbles**

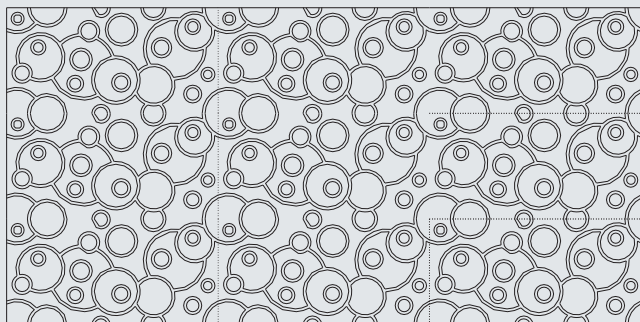

**Turtle**

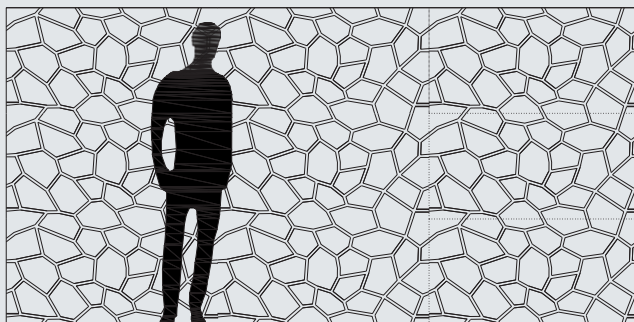

Products may vary from country to country. Please contact your local sales representative.  
For further information and legal notice, please visit our website.

# Потолочные Решения

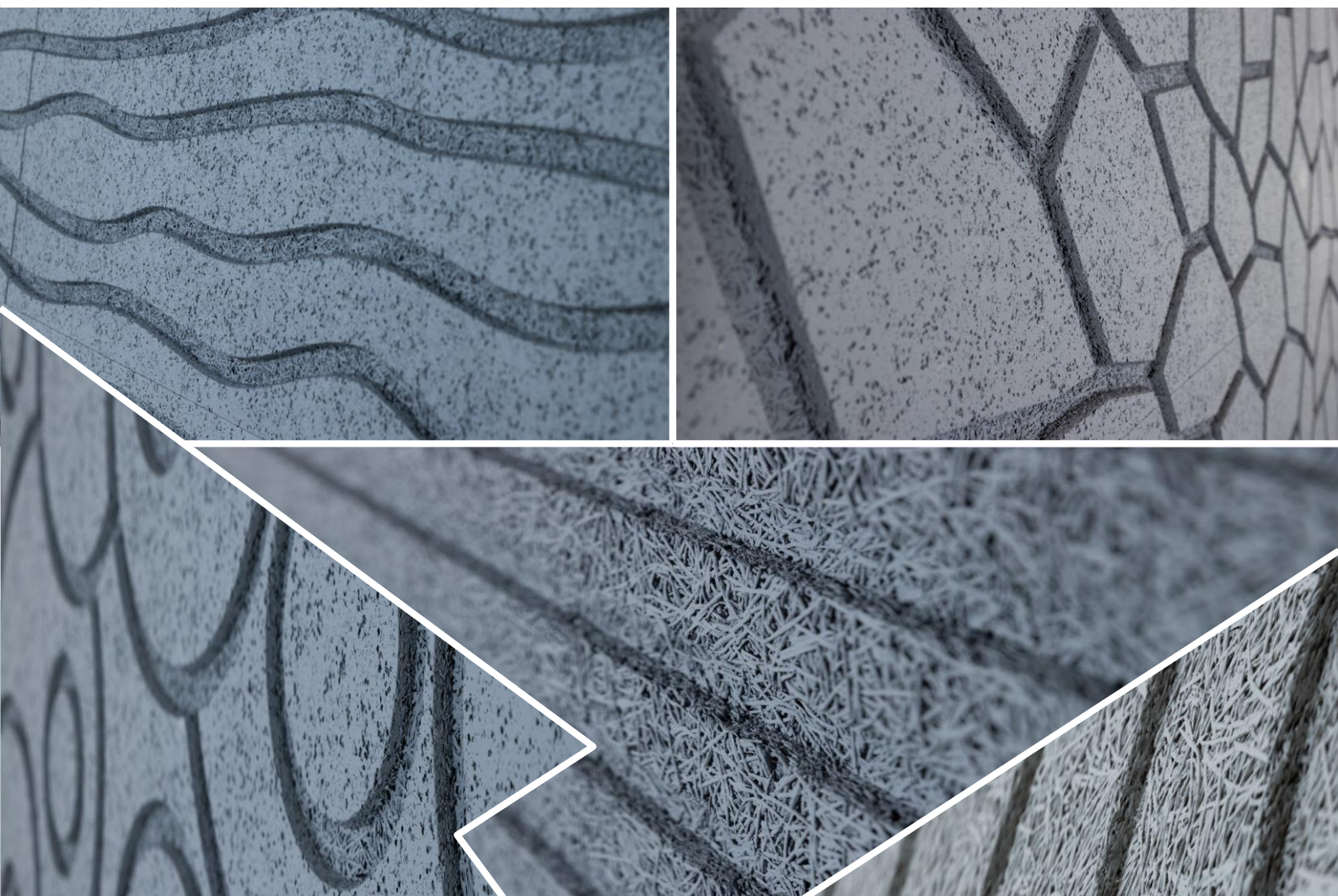

Акустические потолки и  
панели для стен.  
Создавайте эффективные  
пространства вместе с нами

**8(495)504-30-51**

**8(800)333-02-53**